

SIBLEY COUNTY

Article 500 “Enhanced 9-1-1 Ordinance” of the Code of Ordinances of the County of Sibley

ARTICLE 500 SIBLEY COUNTY ENHANCED 911 ORDINANCE

SECTION 500.1 OVERVIEW

SUBD. 500.1.1 This ordinance provides a system to address all primary structures located in Sibley County yet outside of the incorporated limits of municipalities. All owners of primary structures are required to address them in accordance with the standards of this ordinance.

The purpose of this system is to promote the public's health, safety, and general welfare. The system is intended to meet the requirements of the Emergency Telephone Services Act, Minnesota Statutes Chapter 403. This ordinance is authorized by Minnesota Statutes Chapter 394.

SECTION 500.2 DEFINITION OF TERMS

SUBD. 500.2.1 Uniform Addressing System. A uniform system of naming streets, numbering properties, and numbering principle buildings is filed with the County Auditor. The uniform system is included as Attachment 1.

SUBD. 500.2.2 Uniform House Markers. A horizontal sign blade, 18 inches long, 6 inches high, with reflective sheeting on both sides, and with 4 inch letters. A drawing showing the sign blade, post, and placement is included as Attachment 2.

SUBD. 500.2.3 Principle Building. The building housing the principle use of the lot or parcel. A principle building may be for residential, commercial, industrial, public-semipublic, recreational, or other use.

SECTION 500.3 ASSIGNING NAMES AND NUMBERS

SUBD. 500.3.1 The Uniform Addressing System will name all public streets outside the incorporated areas of Sibley County. Platted street names will be added to the Uniform Addressing System.

SUBD. 500.3.2 The Uniform Addressing System will number all lots or parcels outside the incorporated areas of Sibley County.

SUBD. 500.3.3 The Uniform Addressing System will number all principle buildings outside the incorporated areas of Sibley County.

SECTION 500.4 IMPLEMENTATION

SUBD. 500.4.1 Sibley County will erect all road intersection signs outside the incorporated limits of municipalities.

SUBD. 500.4.2 Sibley County will erect all uniform house number signs outside the incorporated limits of municipalities.

SECTION 500.5 RESPONSIBILITIES

SUBD. 500.5.1 Sibley County will maintain the Uniform Addressing System using attachments 1 and 2 for guidelines.

SUBD. 500.5.2 Sibley County will maintain the database of the streets, lots or parcels, and principle buildings.

SUBD. 500.5.3 Sibley County will issue new numbers as development occurs. Sibley County will issue new uniform house marker sign materials to the owner of a lot or parcel for a fee. Sibley County will issue new road intersection sign materials to the local government unit for a fee.

SUBD. 500.5.4 Sibley County will maintain all road intersection signs outside the incorporated limits of municipalities at the following types of intersections: intersections of county and state, county and county, county and township, and county and private roads.

SUBD. 500.5.5 The local government unit will maintain other road intersection signs.

SUBD. 500.5.6 The owner of the lot or parcel will maintain the uniform house marker.

SUBD. 500.5.7 Sibley County will periodically order sign materials for changes, maintenance and replacements.

SUBD. 500.5.8 Municipalities may use the Uniform Addressing System within their incorporated areas.

SECTION 500.6 PAYMENT

SUBD. 500.6.1 Sibley County will pay for the initial road intersection sign and installation.

SUBD. 500.6.2 Changes and maintenance after the initial installation will be paid for by the local road authority. Subdivisions 500.5.4 and 500.5.5 of the RESPONSIBILITIES section describe this further. Sibley County will bill the local road authority.

SUBD. 500.6.3 The cost of the uniform house marker and installation is the responsibility of the property owner of the lot or parcel.

SUBD. 500.6.4 The cost of the initial uniform house marker and installation was included as a line item in the special assessment area of the tax statements payable 2000.

SUBD. 500.6.5 The cost of additional uniform house markers will be included as part of a conditional use permit fee.

SECTION 500.7 PENALTIES

SUBD. 500.7.1 Failure to comply with any section of this ordinance will constitute a petty misdemeanor. It is punishable, upon conviction, of a fine not to exceed \$200.00.

ARTICLE 500 ATTACHMENT 1

SIBLEY COUNTY ADDRESSING SCHEME

1. 1000 addresses per mile section of road (500 odd and 500 even) beginning with 16000 and ascending proceeding south, and 25100 and ascending proceeding west from the northeast corner of Sibley County.
2. No pre or post directional descriptions will be used with street names throughout the rural areas of Sibley County.
3. Roads that run predominantly east/west are designated STREET and assigned numbers at intervals of ten every one mile section of road based on the section line beginning with 158 St. in accordance with the Carver County & LeSueur County addressing scheme. Any roads that fall between the section line will be numbered incrementally with even numbers.
4. Roads that run predominantly north/south are designated AVENUE and assigned at intervals of ten one mile section of road based on the section line beginning with 251 Ave and continuing west. Any roads that fall between the section line will be numbered incrementally with odd numbers.
5. State Highways will retain their name and number. County roads will retain their highway number but will have a number for addressing.
6. Dead end roads will be designated as LN (Lanes) and numbered accordingly to their grid placement.
7. LOOP or CIRCLE shall be designated as all roads that loop back on themselves and numbered accordingly to their grid placement.
8. All roads that do not fall accordingly to the grid and run diagonally will be designated as RD (Road) and given a name should be verified by the county. The address ranges between the control points such as section lines for a meandering road will be spaced out accordingly with the standard odd/even designators remaining constant throughout the entire road segment.
9. All private drives that have two or more residents and are more than 1/8 mile long or with one or more houses that can not be seen from the main road will be named according to the wishes of the residents effected and be designated as LN (Lane). All names must be approved by the county to avoid duplication. It is recommended that names in reference to "Nature" or "Country" be utilized and to avoid personal names such as "Johnson LN".

10. Cartways maintained by the county will be addressed and named as required.

ARTICLE 500 ATTACHMENT 2

APPENDIX D

Typical Uniform House Number Assemblies and Hardware

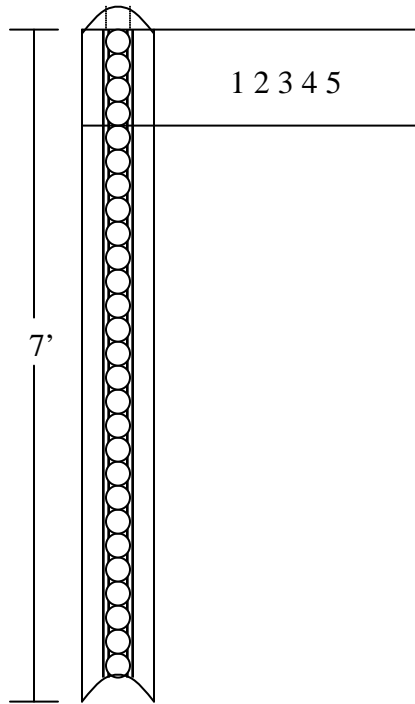

6" x 18" blank
4" numbers
Series C

U shaped channel
Post 1.12 lbs. per ft.,
7/16 holes 1" on
center

36" to 42" above the ground – Sibley County

ARTICLES 500 APPENDIX E

**TYPICAL ASSEMBLY SKETCH
SIGNS, POSTS, ASSEMBLIES & HARDWARE**

SIBLEY COUNTY

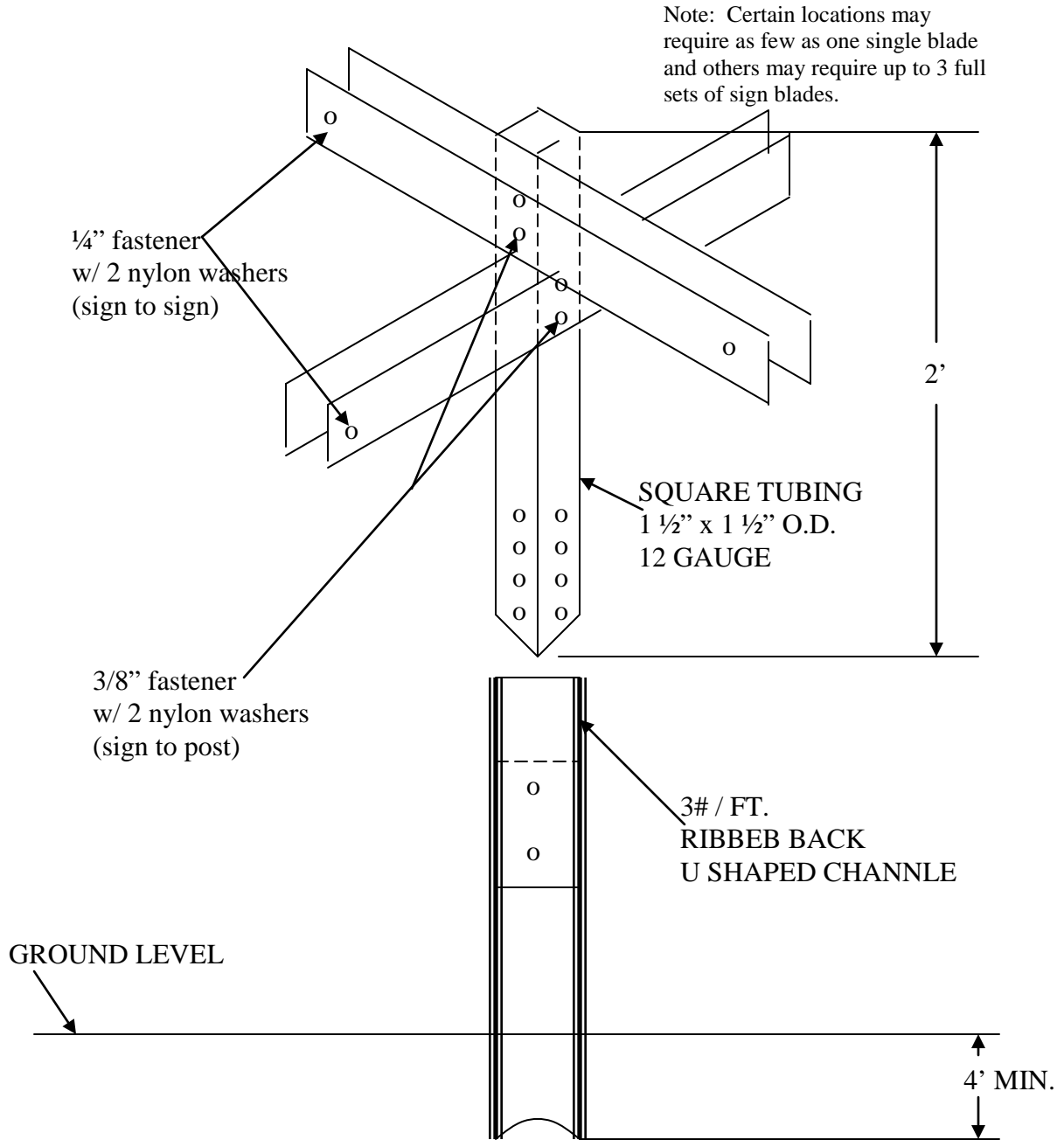

ARTICLE 500 APPENDIX F

TYPICAL HOUSE NUMBER LOCATION

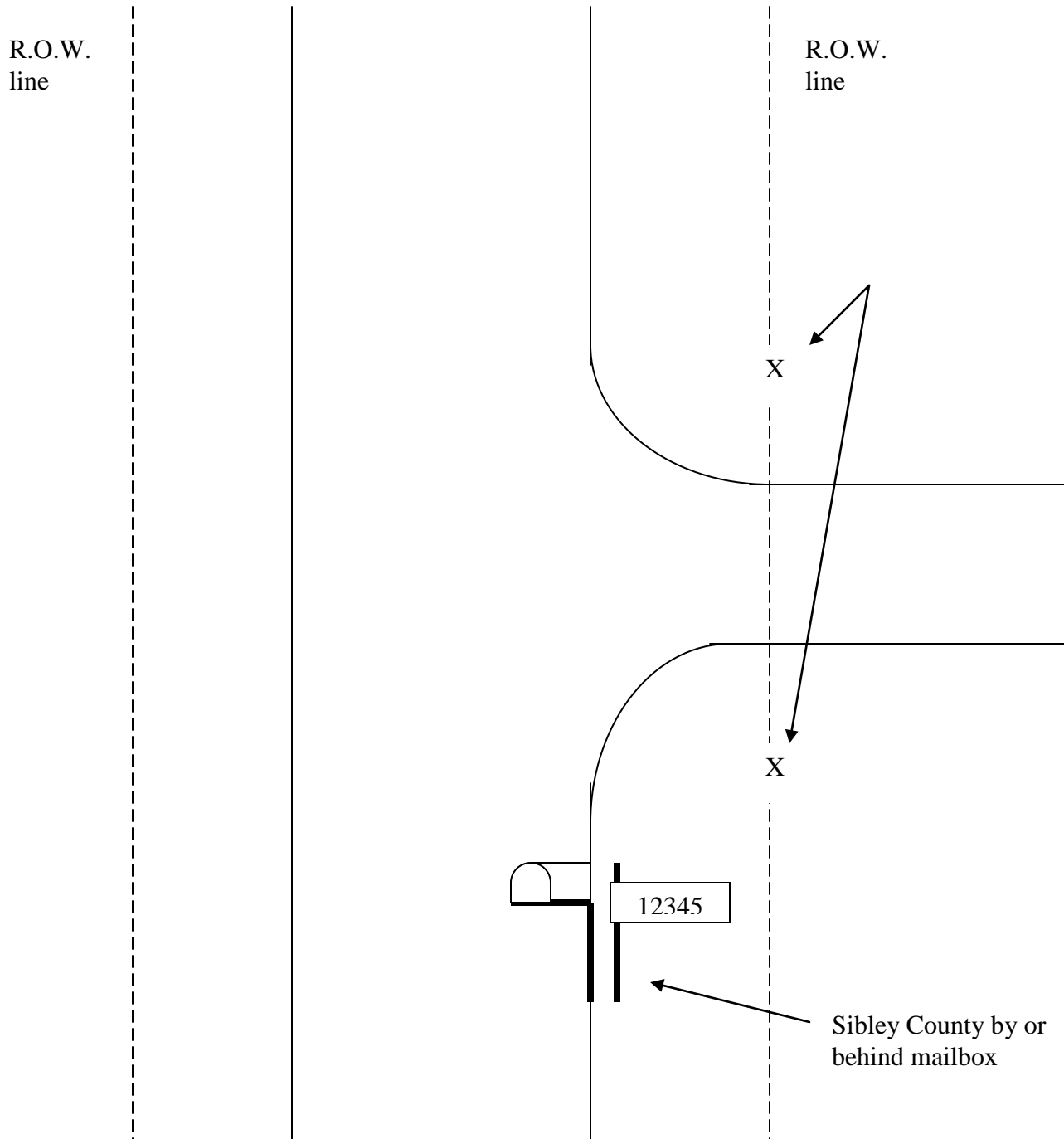

ARTICLE 500 APPENDIX F

TYPICAL INTERSECTION SIGN LOCATION

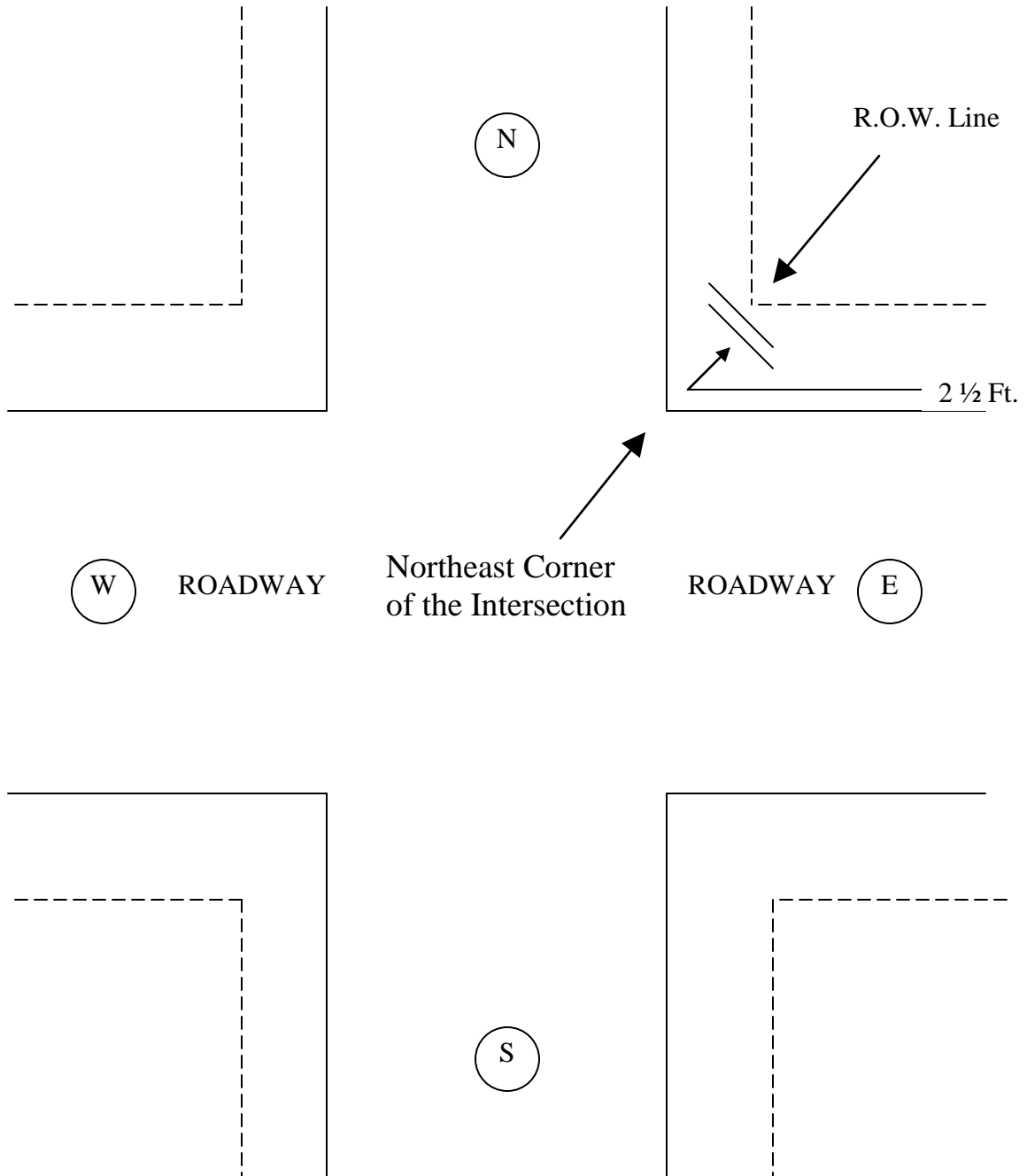

ADDRESS REQUIREMENT FLOWCHART

Is there access (driveway, cartway, etc.) to the structures?

YES

NO

Address required*

Is the structure (or combination of structures) less than 300 sq. ft.?

*Exceptions (address not required):

1. Outbuildings that are part of a

contiguous/continuous site that

already has an address AND

share the same access

2. Outbuildings that are part of a

contiguous/continuous site that

already has an address but are

separate parcels due to a road going

through the site

Is the value of the structure minimal?

YES

NO

Is the value of the structure minimal?

YES

NO

No address required

Will be evaluated and decided by GIS Manager

Will be evaluated and decided by GIS Manager

Address required

Note: Any unique situation that does not reasonably fit the certain criteria contained in this flowchart will be evaluated and decided upon by the Sibley County GIS Manager on a case-by-case basis.

- 300 sq. ft. guide follows the Department of Revenue's definition for "minor ancillary structure"
- Minimal Value = Approximately \$1,000 or less